

Tokiwaso Manga Museum!

and fascinating details



Don't miss the ceiling!



The signpost is written in two different character styles!



Matsuba ramen noodles and rice bowl just like in the 1950s-'60s



charms of Tokiwaso!!

Visitors' Guide

- Operating Hours : 10:00 a.m.-6:00 p.m. (Last admission : 5:30 p.m.)
- Closed : Mondays (or the next non-holiday if Monday is a national holiday), year-end and New Year holidays, exhibit-changing periods, etc.
- Admission Fee : Admission fee required to enter all areas of the Museum during special planned exhibitions (Please check the Museum's website for details.)
- Visitor Rules
 - Visitors must remove their shoes before entering the Museum. As entering barefoot is not permitted, please come wearing socks or bring them with you.
 - Please do not bring food, beverages, or fresh flowers inside the Museum.
 - Pencils are the only writing implements that may be used inside the Museum.
 - Unauthorized posting, distribution, or display of advertisements and sales are not permitted inside the Museum or on the Museum premises.
 - For other information, please refer to "Visitors' Guide" on the Museum's website.
- Parking Lot / Bicycle Parking
 - Please contact the Museum in advance to use the handicapped parking lot (two spaces).
 - There is no general visitors' parking lot. Please use public transportation.

Access

Easily accessible! Just 1 station from Ikebukuro Station and 6 stations (approx. 15 min.) from Shinjuku Station on the Oedo Line

5-min. walk from Ochiai-minami-nagasaki Station (Toei Oedo Line)
10-min. walk from Higashi-Nagasaki Station and 15-min. walk from Shiinamachi Station (Seibu-Ikebukuro Line)

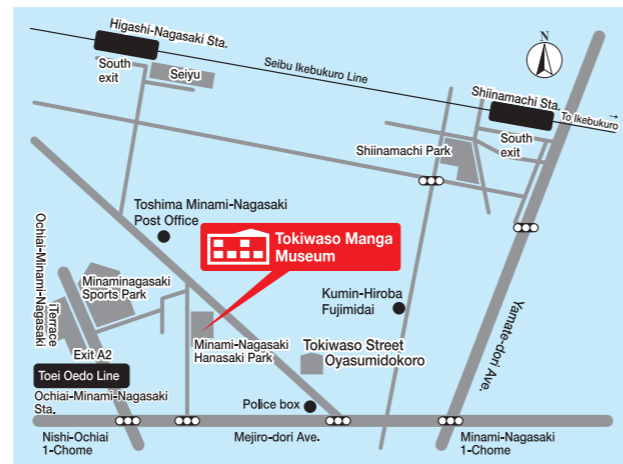

TOSHIMA CITY TOKIWASO MANGA MUSEUM

3-9-22 Minaminagasaki, Toshima, Tokyo (inside Minaminagasaki Hanasaki Park)

TEL : 03-6912-7706

FAX : 03-6912-7749

Official Website

<https://tokiwasomm.jp/en/>



東京都は持続可能な開発目標 (SDGs) を実現しています。 As of Jun. 2022



トキワ荘 マンガミュージアム

TOSHIMA CITY

TOKIWASO MANGA MUSEUM



A sanctuary for manga artists

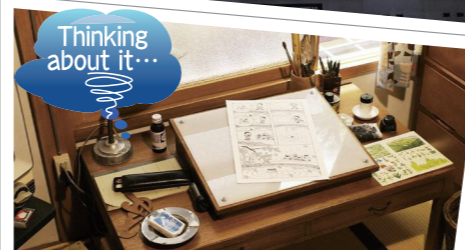

Thinking about it...



Food like in a manga!



Amazing!!



Pitter-patter



Beautiful lighting at night!

Welcome to Filled with secrets

Tokiwaso is the legendary apartment building where Tezuka Osamu and other renowned manga artists spent their youth. It was resurrected here as a sanctuary for manga.



Double wooden doors at the entrance



Did you hear the creaking of the stairs?



Secrets both inside and outside the window!



Experience Tokiwaso as soon as you enter the door!



Even the pictures on the sliding screens were specially drawn.



Discover the

What is the Tokiwaso Manga Museum?

The former Tokiwaso apartment building was completed on December 6, 1952, at the address 5-2253 Shiinamachi in Toshima City. Although it was demolished in December 1982, thanks to the help of many supporters, it was reconstructed as a manga museum. With cooperation from manga and anime lovers, the museum is the site of planned exhibitions and other events as a hub to share manga and anime culture and pass it down to future generations.

Reproduction

The exterior and interior faithfully recreate how Tokiwaso looked when manga artists worked hard together and learned from each other there. You can get a glimpse at the lifestyles of manga artists in the 1950s and '60s.



1 Room 18 Yamauchi Johji

*The workroom used by Ishinomori Shotaro's assistant has been recreated.

2 Room 19 Mizuno Hideko

She moved into Tokiwaso with just a single wicker suitcase.



3 Room 20 Suzuki Shin'ichi Moriyasu Naoya Yokota Tokuo

*The shared room of Suzuki and Moriyasu or Yokota's room is recreated here at different times.



2F Experience the Tokiwaso wooden apartment building in real life!!

Videography is prohibited throughout the Museum. Also, please refrain from taking photographs in areas marked with [X].

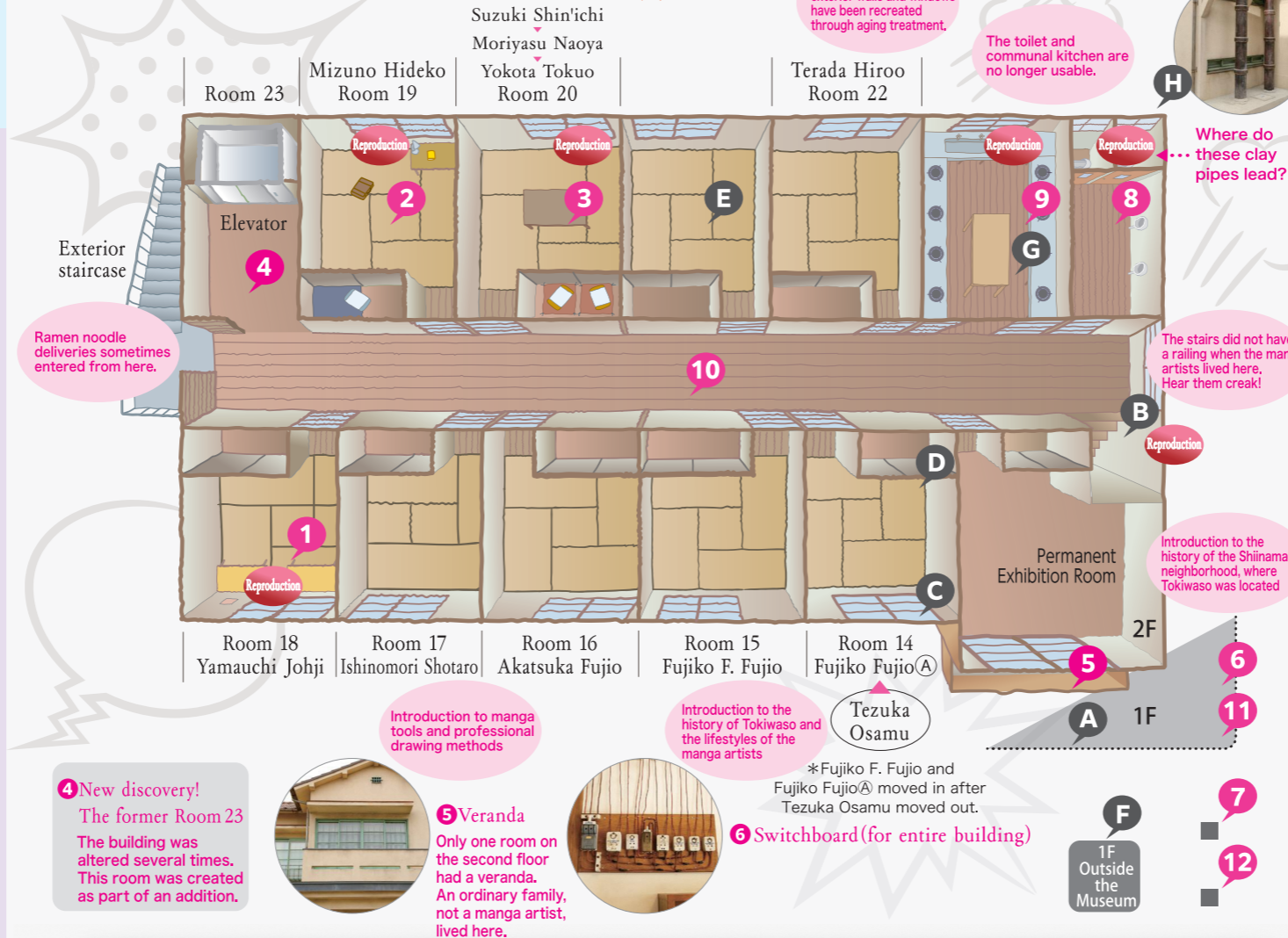

1F Enjoy manga from various angles Manga Lounge & Planned Exhibition Room

■ Manga Lounge: This space displays manga and books connected to Tokiwaso. ■ Planned Exhibition Room: Exhibitions and events related to manga and anime are held here.

Exclusive merchandise related to planned exhibitions is available for purchase!

Connected Manga Artists

Akatsuka Fujio, Ishinomori Shotaro, Suzuki Shin'ichi, Sonoyama Shunji, Tsunoda Jiro, Tezuka Osamu, Terada Hiroo, Nagata Takemaru, Nagatani Kunio, Fujiko F. Fujio, Fujiko Fujio (A), Maruyama Akira (editor), Mizuno Hideko, Moriyasu Naoya, Yamauchi Johji, Yokota Tokuo, Yokoyama Takao

Reproduction



7 Signpost



8 Toilet



9 Communal Kitchen



10 2F Room Layout & Hallway



11 Shoe Cupboard



12 Telephone Booth